

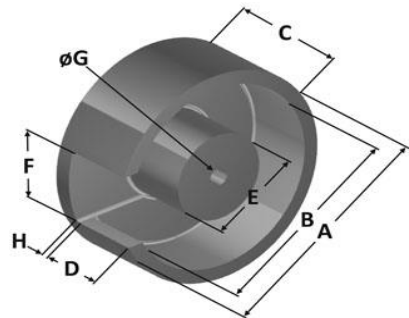

Part Number: PMS-060035-026-2
 Revision: 2026-Apr-30



A	60.50 ± 0.50 mm	2.382 ± 0.020 in
B	51.50 ± 0.50 mm	2.028 ± 0.020 in
C	17.50 ± 0.25 mm	0.689 ± 0.010 in
D	10.25 ± 0.25 mm	0.404 ± 0.010 in
E	25.30 ± 0.30 mm	0.996 ± 0.012 in
F	14.80 ± 0.30 mm	0.583 ± 0.012 in
G	4.50 ± 0.10 mm	0.177 ± 0.004 in
Mass	(approximate)	120 grams/half
Magnetic Dimensions	A _e - Eff. Mag. Cross Section	5.97 cm ²
	L _e - Eff. Mag. Path Length	8.33 cm
	V _e - Eff. Core Volume	49.7 cm ³
	WA - Min. Eff. Window Area	2.54 cm ²
	sa - Surface Area	124 cm ²
	mlt - mean length per turn	12.1 cm
Inductance	μ _i (reference)	26
	A _L value (nominal)	234 nH/N ²
	Test Winding	N=TBD, #TBD AWG
	Frequency	10k Hz
	Voltage on Agilent 4284A	TBD
	A _L tolerance	Ref Only
Core Loss	$\text{Core Loss (mW/cm}^3\text{)} = \frac{f}{\frac{a}{Bpk^3} + \frac{b}{Bpk^{2.3}} + \frac{c}{Bpk^{1.65}}} + d \cdot Bpk^2 \cdot f^2$	
	where B _{pk} expressed in gauss, f expressed in hertz, and: a=1.0000E+06, b=4.9693E+08, c=3.9928E+06, d=2.8671E-14	
	B _{pk}	500 G
	frequency	100k Hz
	Core Loss (nominal)	295 mW/cm ³
Core Loss (maximum)	339 mW/cm ³	
DC Saturation	$\% \mu_i = \frac{1}{a + b \cdot H^c} + d$	
	where H expressed in oersteds, and: a=1.0000E-02, b=1.5296E-06, c=1.6545, d=0.0000	
	H _{DC}	200 Oe
	Percent Initial Perm(nom.)	50.5 %
	Percent Initial Perm(min.)	43.0 %
Coating/Pkg	Coating Type:	Blue Epoxy
	Voltage Breakdown (min.)	N/A
	Limit	N/A
	Package Quantity	TBD Halves/Box

Winding Table	Wire Size	AWG	8	10	12	14	16	18	20	22	24	26	28
		mm	3.150	2.500	2.000	1.600	1.250	1.000	0.800	0.630	0.500	0.400	0.315
	Full Winding	Turns	14	21	33	51	79	122	188	291	451	698	1,080
	Rdc(Ω)	3.5 m	8.3 m	20.7 m	50.9 m	125.4 m	307.9 m	754.6 m	1.9	4.6	11.3	27.7	

Special Spec: Preliminary.

Handling and Storage: Cores should be stored in the original unopened packaging between -10°C and +50°C and less than 60% relative humidity. After the original packaging is opened, the cores should be stored between -8°C and +25°C less than 30% relative humidity. Gloves should be used when handling uncoated cores. The cores should also be sheltered from rain, moisture, salt water, salt air, plasters, ashes, sulfur, sulfur dioxide, ammonia sulfates, soils, acids, metals shavings, and solvents.

Operating Temperature: Cores can be used continuously at operating temperatures between -60°C and +200°C.

RoHS 2.0, REACH and ISO (TS16949, ISO 9001, ISO 14001) compliant. Statements available for download at www.micrometalsapc.com.

