

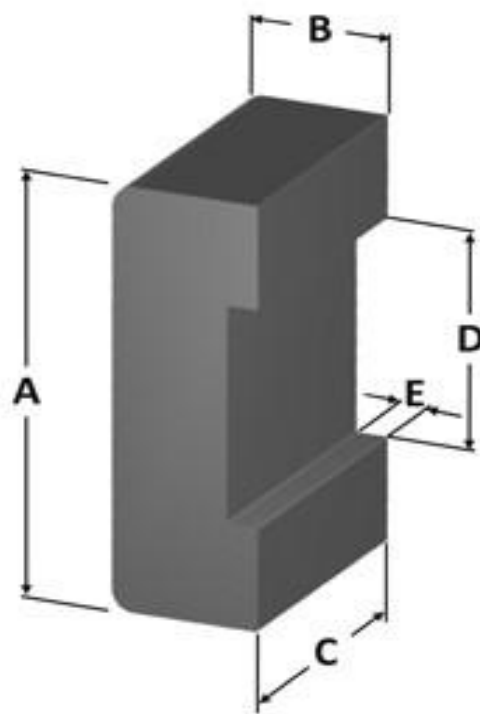

Part Number: **HS300-8B**

Revision 20200407 - Generated 2020-Apr-07



A	25.91 ± 0.38 mm	1.020 ± 0.015 in
B	8.26 ± 0.25 mm	0.325 ± 0.010 in
C	19.05 ± 0.51 mm	0.750 ± 0.020 in
D	13.21 mm (nom.)	0.520 in (nom.)
E	1.78 mm (nom.)	0.070 in (nom.)
Mass	(approximate)	22 grams/half
Magnetic Dimensions	A _e - Eff. Mag. Cross Section	1.21 cm ²
	L _e - Eff. Mag. Path Length	5.92 cm
	V _e - Eff. Core Volume	6.92 cm ³
	WA - Min. Eff. Window Area	0.449 cm ²
	sa - Surface Area	24.7 cm ²
Inductance	mlt - mean length per turn	5.82 cm
	μ _i (reference)	35
	A _L value (nominal)	95 nH/N ²
	Test Winding	N=25, #26 AWG
	Frequency	10 kHz
Core Loss	Voltage on Agilent 4284A	0.13 V
	A _L tolerance	±10%
	Core Loss(mW/cm ³)= $\frac{f}{\frac{a}{B_{pk}^3} + \frac{b}{B_{pk}^{2.3}} + \frac{c}{B_{pk}^{1.65}}} + d \cdot B_{pk}^2 \cdot f^2$	
	where B _{pk} expressed in gauss, f expressed in hertz, and: a=1.90E+09, b=2.00E+08, c=9.00E+05, d=5.00E-15	
	B _{pk}	140 G
DC Saturation	frequency	100 kHz
	Core Loss (nominal)	32 mW/cm ³
	Core Loss (maximum)	36 mW/cm ³
	%μ _i = $\frac{1}{a + b \cdot H^c} + d$	
	where H expressed in oersteds, and: a=1.00E-02, b=3.49E-06, c=1.43, d=0.00	
Coating/Pkg	H _{DC}	200 Oe
	Percent Initial Perm(nom.)	60.1%
	Percent Initial Perm(min.)	53.7%
	Coating Type:	Yellow epoxy, outer surface only
	Voltage Breakdown (min.)	N/A
Limit	N/A	
Package Quantity	600 Halves/Box	

